

GG MACHINE[®]
Wrapping Machine Packaging Automation

PAIKPAC

派楷包装设备（上海）有限公司

电话：021-69775066

邮箱：info@paikpac.cn

网址：www.paikpac.cn



CE

ENG - 中文

型号 AT-A AT-A.大尺寸 全自动型



Established in 1974 **GG Machine** is today a leading manufacturer of horizontal, automatic machines and plants for the packaging with stretch film and / or other types of polyethylene film. **GG Machine** produces horizontal wrapping machines with rotating ring for a spiral banding and entire plants named Total Closing, for the complete cold closure of the package (without shrink tunnel).

The leadership of **GG Machine** was born in the field, where the technological capacity and intelligence are measured continuously to solve production problems. The products **GG Machine** are always renewed according to the demands of the market and are subdued to constant upgrades.

The different basic models, thanks to their modular system, in combination to a wide range of accessories, are extremely versatile and adapt themselves fully to the packaging of countless products of different shapes and sizes.

GG Machine is active in Italy and abroad, distinguishing them by a great flexibility of design, reliability and robustness of the machines. The utilisation of material and components of high quality minimises the wear and spare parts, eliminating almost the maintenance costs.

GG Machine has an equipped warehouse of spare parts, with always available standard components, to be always able to satisfy the requests of the customer promptly. Urgent order can be processed within 24 hours in Europe, and within 48 for the rest of the world. It is possible to send technical enquiries and/or requests for assistance to

GG Machine 公司成立于1974年，现在已是一家技术领先水平的自动机械和拉伸缠绕包装设备制造商。**GG MACHINE**生产水平式缠绕机和顶部覆膜机系列产品，是完全冷式包装形式，不需要热收缩炉子。

GG Machine 是这个领域的领导者，我们在这个领域中的技术能力和智慧不断地壮大，解决产品包装问题。**GG Machine** 始终根据市场需求进行更新，并不断升级。

不同的基本型号，由于模块化系统，结合了通用的备件，具有极强的通用性，完全适应不同形状和尺寸的产品包装。

GG Machine 是一家意大利的家族企业，其特点是设计的灵活性，可靠性和机器的寿命长，利用高质量的材料和部件，将磨损和备件将至最低，维护成本低。

GG Machine 拥有一个装备齐全的备件仓库，配置随时可用的标准件，能够及时满足客户的需求。



全自动水平式缠绕机

型号 AT-A

STRETCH FILM
SPOOL DIAMETER Ø 250 mm
WIDTH 125 - 250 - 500 mm

STRETCHFILM
SPULE Ø 250 mm
BREITE 125 - 250 - 500 mm



Mod. AT 1200 A

Top model of the range GG Machine for the Automatic series.
The machines of the series AT-A are built using our well known and tested ROBUSTNESS STRUCTURE MONO-BLOCK.
Made entirely of heavy steel and suitable for spools of stretch film of a width up to 500 mm. The modular system with which they are designed and assembled allows to accomplish the specific requirements of the customer.
The DOUBLE SPOOL solution makes it possible to achieve extremely high performances, projecting the AT-A series to levels of absolute excellence and consolidating GG Machine's position as global market leader in the industry.
The use of material which reduces wear and spare parts caps the maintenance costs. In the series AT - A the cycle is fully automatic. Their employment can happen with or without the aid of the operator and they can be insert in completely automatic lines.

They are furnished with motorised roller or band conveyors, photocells for the detection of the product, horizontal pneumatic pressures to stabilise the product and 8 different wrapping programs to meet the different needs of packaging of the customer depending on the kind of product. The series AT-A is appropriated for companies that have an elevated daily production.

Perfect for the wrapping of doors, windows, cabinet doors, furniture kit, mounted furniture, wooden profiles, plastic and metal, aluminium extrusions, cardboard boxes, panels of wood or metal, sandwich for constructions, panels for the isolation, products with irregular shape etc.

GG Machine 高等级全自动系列

AT-A 系列使用了我们通过测试和制造的高强度结构的环体
高强度的钢结构特别适应到最大膜卷高度500mm. 该系统它们被设计和组装满足客户的需求.
双膜架是高性能和高产能的解决方案, 让我们成为市场的领导者.
我们所用的材料都是节省磨损和备件, 降低了维护维修成本.

GG Machine 高等级全自动系列

他们是集成在动力滚筒式输送机或者皮带式输送机, 光电自动侦测产品, 气动压力滚筒确保了产品和8种不同的包装模式满足各种包装需求和不同类型的产品.
AT-A系列完全满足和适用于日产量提高的工厂

适用于门、窗、柜门、家具套件、安装家具、木材、塑料和金属、铝挤压件、纸板箱、木板或金属板、建筑夹层、隔离板、不规则形状产品等的包装。

全自动水平式缠绕机

型号 AT-A .大尺寸

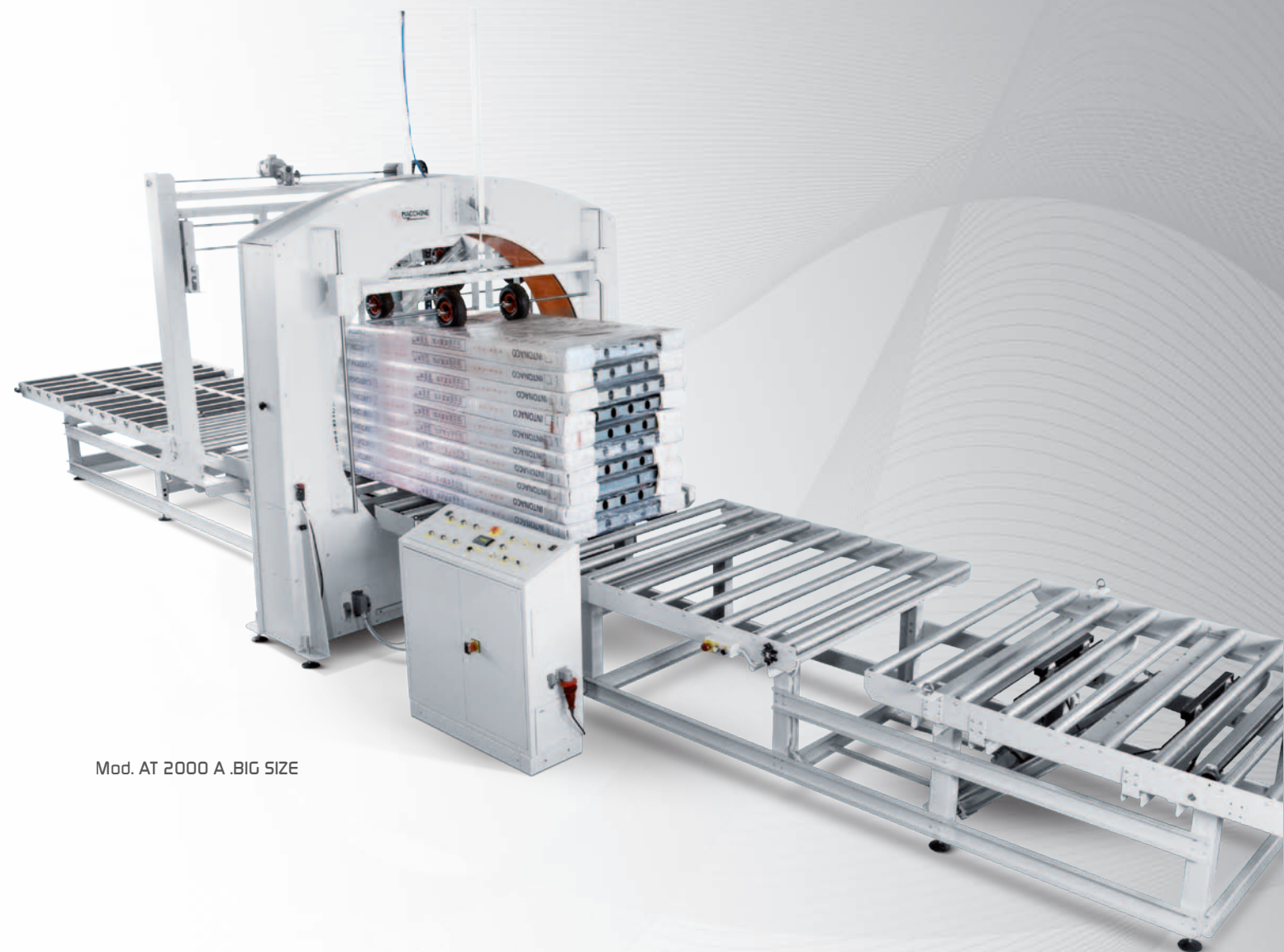

Mod. AT 2000 A .BIG SIZE

The machines of the series BIG-SIZE are build utilising the ROBUSTNESS STRUCTURE, made entirely of heavy steel and suitable for spools of stretch film of a width up to 500 mm.
Developed like the series AT-A, they have the same technical and functional properties.

The BIG SIZE series of wrapping machines have a large diameter rotating ring and are suitable for packaging large-sized products on or off pallets.

Large loads of wooden, metal, composite sandwich panels, insulation panels with or without pallet bases, furniture kits, assembled furniture, doors, windows, and other wooden articles.
For packs of polystyrene, polyurethane, glass, paper rolls, plastic, and large-sized products.

该系列大尺寸机器采用坚固结构制造, 完全由重型钢制成, 适用于宽度达500mm的拉伸膜卷。
设计开发和制造了AT-A系列, 它们具有相同的技术和功能特性。

该系列包装机具有大直径旋转环, 适用于大型产品包装。

大量的木制、金属、复合夹芯板、带或不带托盘底座的绝缘板、家具套件、组装家具、门、窗和其他木制物品。
适用于聚苯乙烯、聚氨酯、玻璃、纸卷、塑料和大型产品的包装。

RANGE OF MODELS

产品型号

AT 300 A
AT 600 A
AT 900 A
AT 1200 A
AT 1500 A

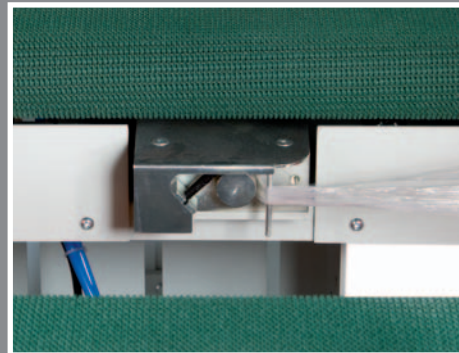

The automatic film hooking, cutting and holding unit allows the automation of the wrapping process.

气动夹膜器和切膜机构, 自动运行在全自动包装过程中



The spool holder unit is in an easy-to-reach position for a fast change of the spool and insertion of the film.

缠绕膜更换快速和方便
通过透视窗可以看到膜消耗量和运行状态;
操作者打开膜架安全窗, 快速更换新膜卷

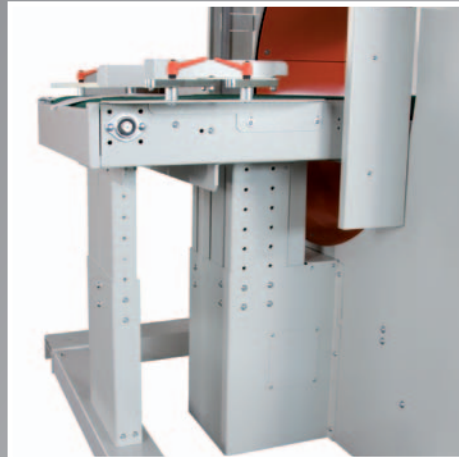

The motorised conveyors are fixed directly on the central structure of the machine through two groups of support that allow the movement of heavy products.

动力输送机固定在中心线上, 输送机带可调节 升降底座, 支撑产品运行

TECHNICAL PROPERTIES

- Rotation steel unit, high load capacity, driven by wheels which are dragged by a belt.
- Spool holder and gear roller with mechanical adjustable clutch.
- Automatic unit of hooking, holding and cutting.
- Photocell to survey the product for the start and stop of the wrapping cycle.
- PLC to control the wrapping cycle.
- 8 banding programs.
- Ring rotation speed variable.
- Conveyor speed electronically variable through inverter.
- Pneumatic pressure group with free rollers input and output.
- Motorised belt input and output.
- Side guides in the input and output.
- Power supply voltage 220V 50-60 Hz single-phase.
- Air pressure in exercise: 6 bar.
- Compressed air consumption: 7 NL/min.
- Motorised conveyors in the input and output.

技术描述

- 驱动轮驱动旋转环旋转
- 膜架和齿轮辊机械膜架, 离合器调节束紧力
- 气动冷切割和夹膜器
- 光电自动侦测产品启动和停止缠绕机
- PLC控制包装周期
- 触摸屏显示和管理机器设置参数, 有多达8种缠绕膜包装形式
- 进料和出料的动力输送机
- 旋转环的速度可调节, 变频器调节
- 垂直气动压力轮在进料和出料输送机处
- 气压: 6bar
- 压缩空气消耗量: 7NL/分钟
- 电源: 220V 50HZ 单相



Mod. AT 300 A

RANGE OF MODELS

产品型号

AT 1800 A .BIG SIZE
AT 2000 A .BIG SIZE
AT 2200 A .BIG SIZE
AT 2500 A .BIG SIZE

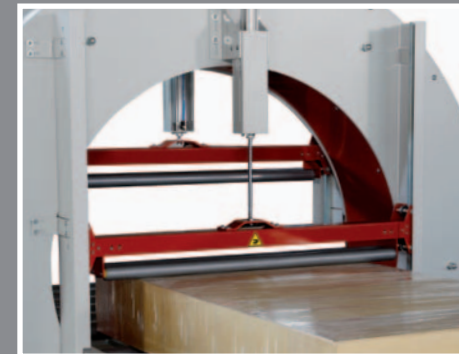

Vertical pressure with free rollers in the input and output pneumatically operated ensures a stable position of the product during the wrapping.

2套垂直压力轮分别位于进料口和出料口, 气动运行方式, 在缠绕过程中分别压住货物, 保证缠绕过程中的稳定性。

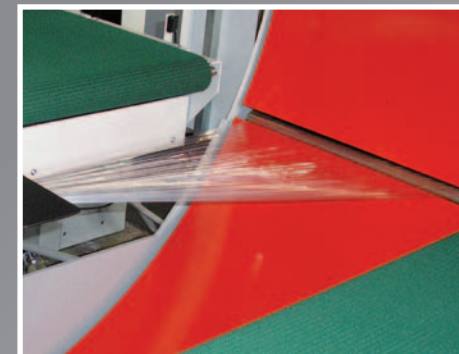

The complete closure of the machine ensures the highest security level.

机器封闭式确保最大的安全等级和水准。



From the panel the functions are controlled through the PLC, used to regulate all variable parameters and select one of the 8 banding programs. In analog mode, the speed of the rotation unit and conveyor can be adjusted using two potentiometers.

从彩色触摸屏可设置包装参数, 包装模式等, 直接联线到PLC中, 它控制了所有的机器运行。
可储存的配方清单, 允许定制化的包装程序根据不同产品的包装要求。



Mod. AT 1800 A .BIG SIZE

全自动水平式缠绕机

可选项配置

OPTIONAL ACCESSORY

OPTIONAL ACCESSORY

可选项

NEW



The functions are managed from the control panel with a colour touch screen, connected directly to the PLC control, which manages all functions of the machine. The ability to store a list of recipes allows custom programming according to the packaging requirements of each product.

这些功能由带彩色触摸屏的控制面板管理,直接连接到PLC控制,后者管理机器的所有功能。存储配方列表的能力允许根据每个产品的包装要求定制编程。

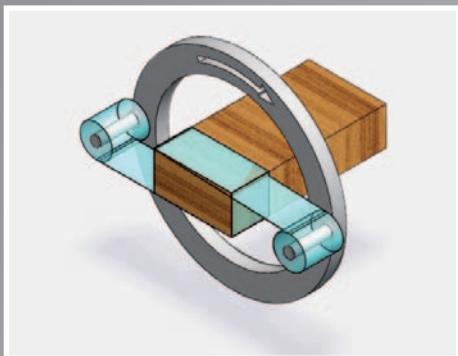

DOUBLE SPOOL
This optional accessory makes it possible to achieve high production capacity.

双膜架
可选项机构确保完成产品输出,提高最大化的生产效率。



APPLICATION: palletizer positioned on the output conveyor.
PRODUCTION NEED: to pack each single product, palletise 10 at a time, perform a final package of the whole block. The loading and unloading of the products must be always carried out from the input.
SOLUTION: the production flexibility of GG Macchine enabled the realisation of the combination of an AT-A BIG-SIZE with a palletizer. In order to be able to load and unload always from the same side the products, the wrapping machine is designed to work in both directions.

应用: 码垛机位于输出传送带上。
生产需要: 对每件产品进行包装, 一次码垛10个, 最后进行整块包装。产品的装载和卸载必须始终从输入开始进行。解决方案: GG Macchine的生产灵活性使AT-A大尺寸与码垛机的结合得以实现。为了能够始终从产品的同一侧装卸, 包装机设计为双向工作。

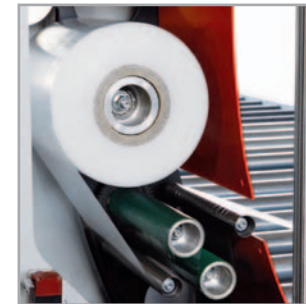

MECHANICAL PRE-STRETCH OF THE FILM OF 100%

It reduces the consumption of the stretch film of 100%. It allows a better packaging at a lower cost.

机械式预拉膜架100%

降低膜的消耗量, 预拉比100%, 降低膜的消耗成本

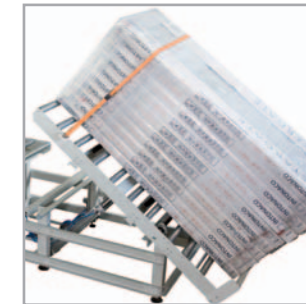

FREE TILT ROLLER CONVEYOR

System to load and unload the product vertically. Facilitates the positioning of bulky products.

上料台

该单元是上料或下料采用垂直, 节省体力, 降低劳动强度



THREAD-PACKAGE OPENER

This is our exclusive system inserts the Thread-Package Opener that allows an easy opening of the packing without the use of a blade or other tools that could damage the surface of the product.

拆包拉绳单元

这是我们专利系统, 将绳子自动放入产品和缠绕膜之间在包装过程中, 客户通过拉绳将膜开口, 不需要尖锐的刀开膜, 造成产品的损伤

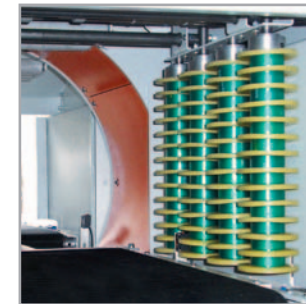

PNEUMATIC CENTRALISING UNIT

Centralises on the conveyor automatically the product, of any width. Device that finds his application for products the wrapping of products width different widths. This device replaces the manually side guides, supplied on the standard models.

气动校正单元

自动校正机构将产品矫正在输送机的中心线上, 并且自动适应不同的产品宽度, 取代了手动调节校正机构

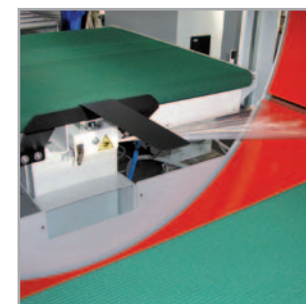

BRIDGE FOR SHORT PIECES

Bridge for short pieces allows for wrapping products with reduced lengths.

过桥过渡件

过桥过渡件让产品顺利通过



END FILM ALARM

Signalises automatically through an optical / acoustical alarm that the stretch film is running out.

无膜报警

信号等自动显示和闪烁报警当缠绕膜消耗完毕后



END FILM WELDING

Unit of hooking and cutting of the film with integrated End Film Welding. Ensures the hooking, the cutting and the welding of the film, with a perfect close fitting on the product.

拆包拉绳单元

夹膜和切膜机构自动将膜尾部抓住和切断膜, 同时热封机构将尾膜热粘合在膜之间, 保证了包装美观和不拖尾

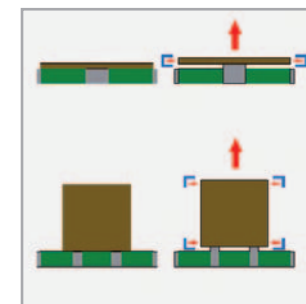

PNEUMATIC ELEVATOR

Device with single or double elevator bar. Lifts the product from the conveyors enables to apply the corner protections around the perimeter of the product.

气动提升单元

单个或者多个提升机构, 将产品腾空, 方便操作者将护角, 护边或者泡沫等放置在产品的四周, 形成保护包装

MODEL / MODELL	125 250 500			125 250 500			125 250 500			125 250 500			125 250 500		
Film width (mm) - 膜宽(mm)	125	250	500	125	250	500	125	250	500	125	250	500	125	250	500
Ø Max film spool (mm) - 最大Ø F直径 (mm)	250	250	-	250	250	-	250	250	250	250	250	250	250	250	250
Ø Core diameter (mm) - 最大纸芯直径 Ø (mm)	76	76	-	76	76	-	76	76	76	76	76	76	76	76	76
Rot. speed (rpm) - 旋转速度 (rpm)	200	150	-	120	100	-	120	100	60	110	80	50	90	70	50
Conveyor speed (m/min) - 输送机速度 (m/min)	20	30	-	10	20	-	10	20	27	10	16	22	10	16	22
Installed powerfull (kW) - 功率 (kW)	1,5	1,5	-	1,1	1,1	-	1,1	1,1	2,2	1,85	1,85	3	1,85	2,25	3
Power Supply - 电源	220 V SINGLE 50/60 HZ			220 V SINGLE 50/60 HZ			220 V SINGLE 50/60 HZ			220 V SINGLE 50/60 HZ			220 V SINGLE 50/60 HZ		
Weight (Kg) - 重量(Kg)	350	450	-	450	600	-	600	750	900	800	1000	1200	1000	1200	1400

	AT 1800 A .BIG SIZE			AT 2000 A .BIG SIZE			AT 2200 A .BIG SIZE			AT 2500 A .BIG SIZE		
Film width (mm) - 膜宽(mm)	125	250	500	125	250	500	125	250	500	125	250	500
Ø Max film spool (mm) - 最大Ø F直径 (mm)	250	250	250	250	250	250	250	250	250	250	250	250
Ø Core diameter (mm) - 最大纸芯直径 Ø (mm)	76	76	76	76	76	76	76	76	76	76	76	76
Rot. speed (rpm) - 旋转速度 (rpm)	80	60	40	70	50	40	70	50	40	50	35	30
Conveyor speed (m/min) - 输送机速度 (m/min)	10	13	18	8	10	18	8	10	18	6	7	13
Installed powerfull (kW) - 功率 (kW)	2,25	3	3	2,25	3	3	2,6	3,3	3,3	3,7	5,5	5,5
Power Supply - 电源	400 V 3 PH+T 50/60 HZ			400 V 3 PH+T 50/60 HZ			400 V 3 PH+T 50/60 HZ			400 V 3 PH+T 50/60 HZ		
Weight (Kg) - 重量(Kg)	1300	1500	1800	1500	1700	2000	1750	1950	2250	2000	2200	2500

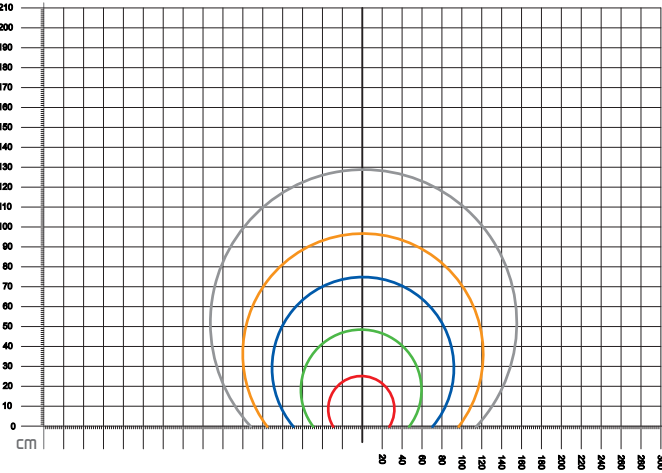

■ AT 300 A	Diameter for passing / 环通过直径	340 mm
■ AT 600 A	Diameter for passing / 环通过直径	630 mm
■ AT 900 A	Diameter for passing / 环通过直径	910 mm
■ AT 1200 A	Diameter for passing / 环通过直径	1220 mm
■ AT 1500 A	Diameter for passing / 环通过直径	1550 mm

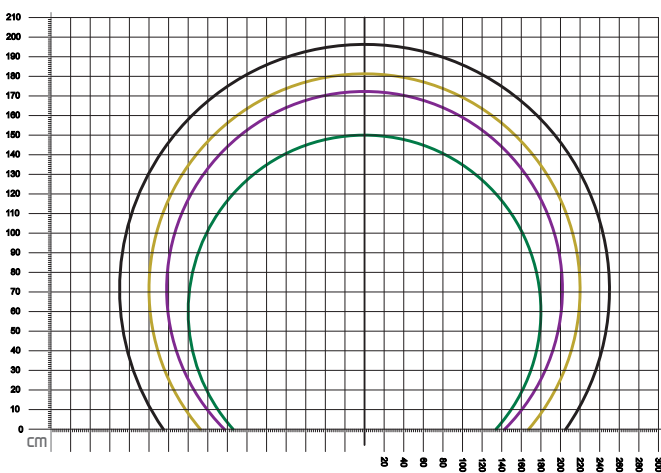

■ AT 1800 A .BIG SIZE	Diameter for passing / 环通过直径	1800 mm
■ AT 2000 A .BIG SIZE	Diameter for passing / 环通过直径	2000 mm
■ AT 2200 A .BIG SIZE	Diameter for passing / 环通过直径	2200 mm
■ AT 2500 A .BIG SIZE	Diameter for passing / 环通过直径	2500 mm

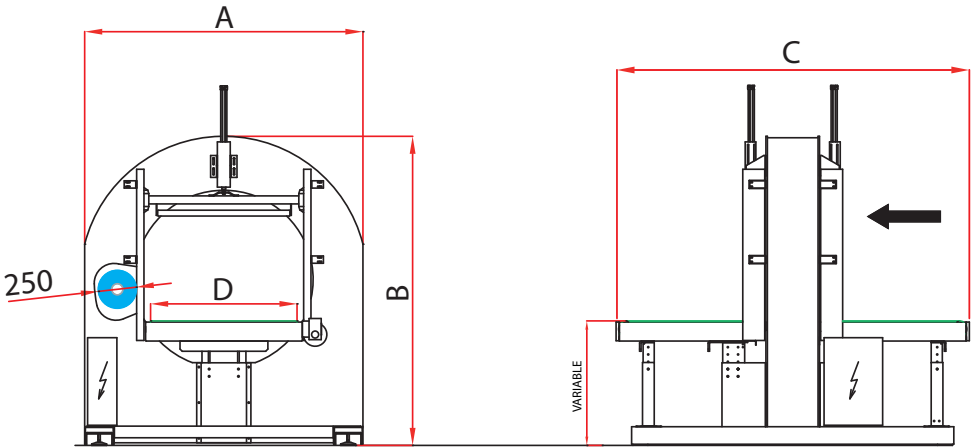

MODEL 型号	FILM WIDTH (mm) 膜宽(mm)	A mm	B mm	C mm	D mm
AT 300 A	125	1000	1530	1280	250
	250	1000	1530	1420	250
AT 600 A	125	1350	1720	1600	400
	250	1350	1720	1720	400
AT 900 A	125	1525	1830	1600	650
	250	1525	1830	1720	650
	500	1525	1830	2080	650
AT 1200 A	125	1900	2180	2260	1000
	250	1900	2180	2400	1000
	500	1900	2180	2750	1000
AT 1500 A	125	2260	2450	2260	1240
	250	2260	2450	2400	1240
	500	2260	2450	2750	1240

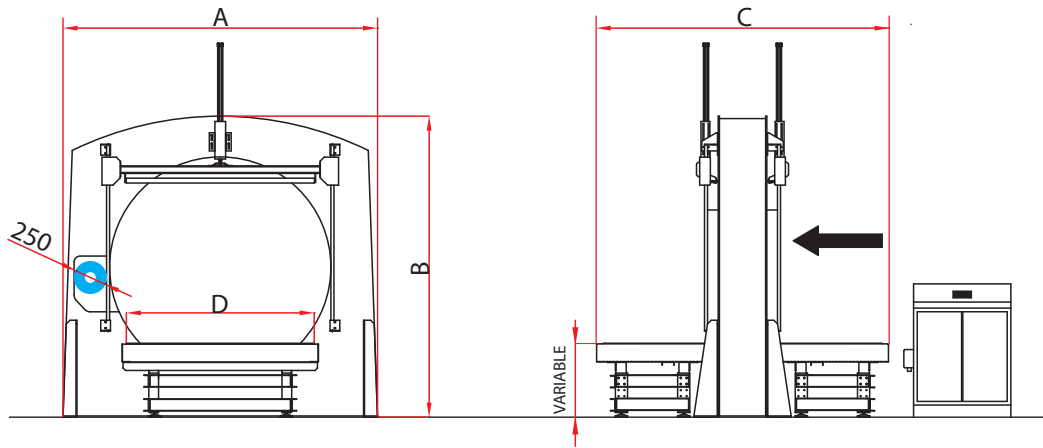

MODEL 型号	FILM WIDTH (mm) 膜宽(mm)	A mm	B mm	C mm	D mm
AT 1800 A .BIG SIZE	125	2500	2550	2260	1545
	250	2500	2550	2400	1545
	500	2500	2550	2750	1545
AT 2000 A .BIG SIZE	125	2800	2700	2260	1700
	250	2800	2700	2400	1700
	500	2800	2700	2750	1700
AT 2200 A .BIG SIZE	125	3000	2900	2260	1900
	250	3000	2900	2400	1900
	500	3000	2900	2750	1900
AT 2500 A .BIG SIZE	125	3300	3200	2260	2200
	250	3300	3200	2400	2200
	500	3300	3200	2750	2200

水平式缠绕机 定制化方案



G.G. Macchine srl

Via Libero Grassi, 1 - Loc. Rabatta
50032 Borgo San Lorenzo - Firenze - Italy
Tel. - Fax (+39) 055 8490265

PAIKPAC

派楷包装设备（上海）有限公司

电话：021-69775066

邮箱：info@paikpac.cn

网址：www.paikpac.cn

MADE IN ITALY

